

HOW TO USE THIS MANUAL

Each repair method description provided in Section RE of this manual comprises two pages, divided into 2 blocks (REMOVAL AND INSTALLATION) and includes illustrations to facilitate body repair.

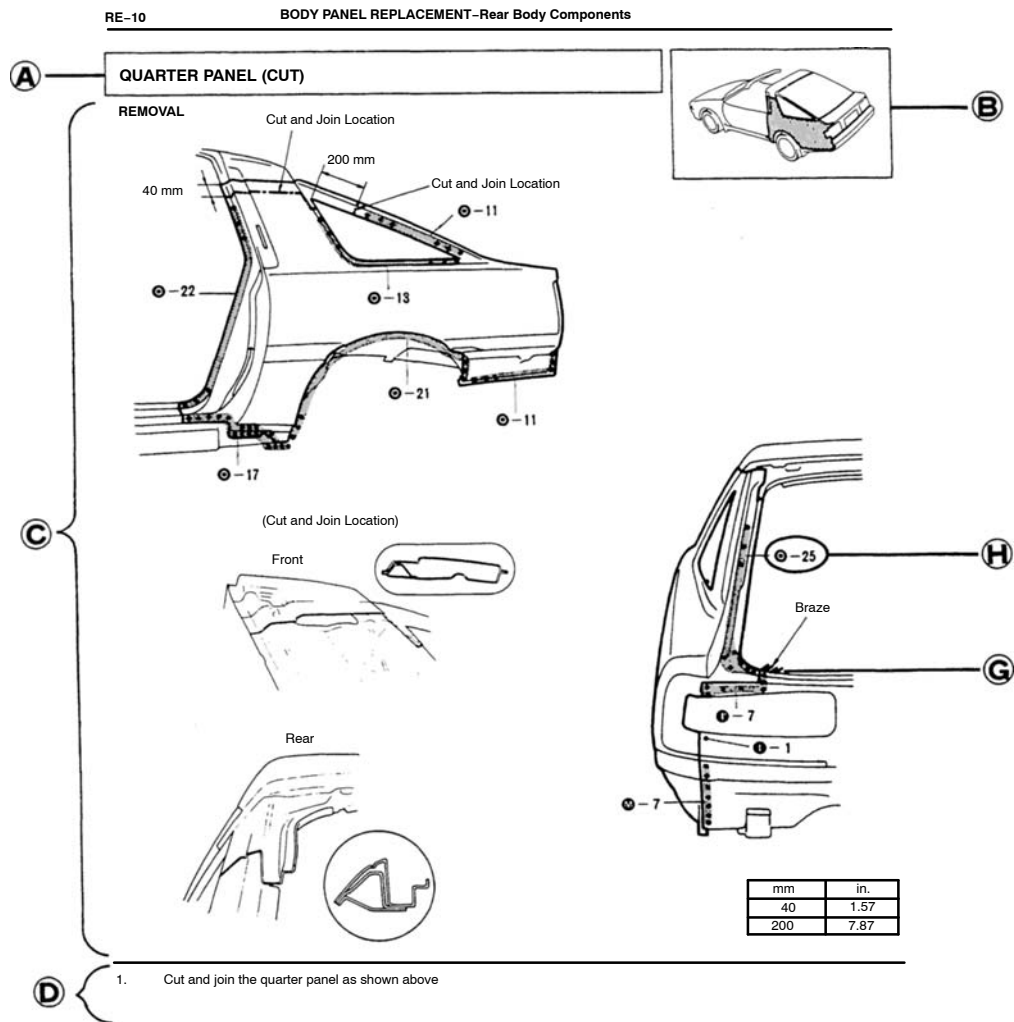

**A** REPLACEMENT PART AND METHOD

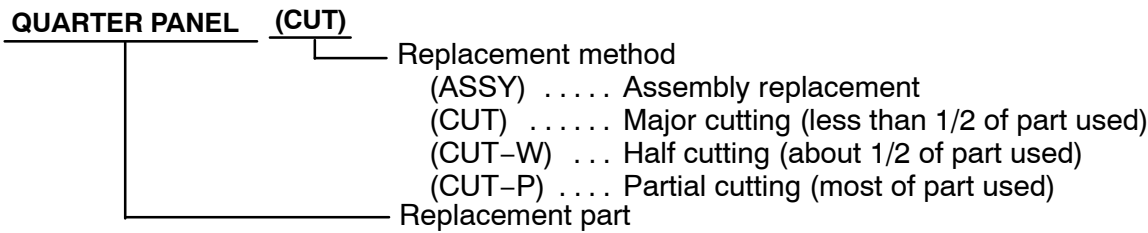

**B** BODY VARIATIONS AND PART LOCATION

Body variations: Non . . All models

**C** REMOVAL DIAGRAM

Describes in detail removal of the damaged part involving repair by cutting.

**D** REMOVAL GUIDE

Provides additional information to more efficiently help you perform the removal.

## BODY PANEL REPLACEMENT—Rear Body Components

RE-11

## INSTALLATION

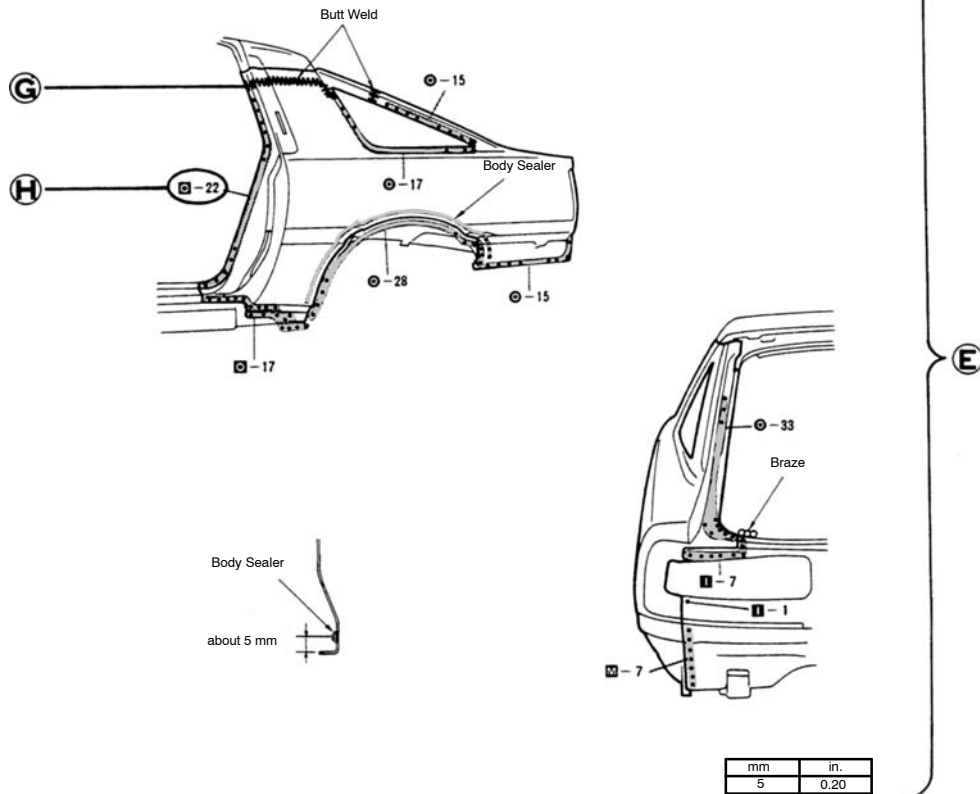

1. Before temporarily installing the new part, apply body sealer to the wheel arch portion.
2. Temporarily install the new part and check the fit of the removable roof and front door.

## NOTE:

- 1) Apply sealer about 5 mm (0.20 in.) from the flange, avoiding any oozing.
- 2) Apply evenly, about 3 – 4 mm (0.12 – 0.16 in.) in diameter.
- 3) For other sealing points, refer to section SU.

**E** INSTALLATION DIAGRAM

Describes in detail installation of the new part involving repair by welding and/or cutting, but excluding painting.

**F** INSTALLATION GUIDE

Provides additional information to more efficiently help you perform the installation.

**G** SYMBOLS

See page [IN-4](#).

**H** ILLUSTRATION OF WELD POINT

Weld method and panel position symbols.  
See page [IN-5](#).